

Control handwheels

Aluminium black, anodized

SPECIFICATION

Types

- Type **A**: without handle
- Type **D**: with revolving handle

Bore codes

- Version **B**: without keyway
- Version **K**: with keyway
- Version **Z**: with collet

Aluminium
anodized, black

Hub cover
Plastic, light grey

Collet / Hexagon nut
Brass

Stainless Steel-Grub screw DIN 916
with internal hexagon and serrated point

Revolving cylindrical handles
Plastic, Technopolymer
black, matt



INFORMATION

Control handwheels GN 736 are used for setting operations with low torque.

Coarse setting is made by means of the cylindrical handle (fingertip grip) followed by fine setting using the knurled rim of the handwheel.

TECHNICAL INFORMATION

- Keyway P9 DIN 6885 (see page A16)
- ISO-Fundamental Tolerances (see page A21)

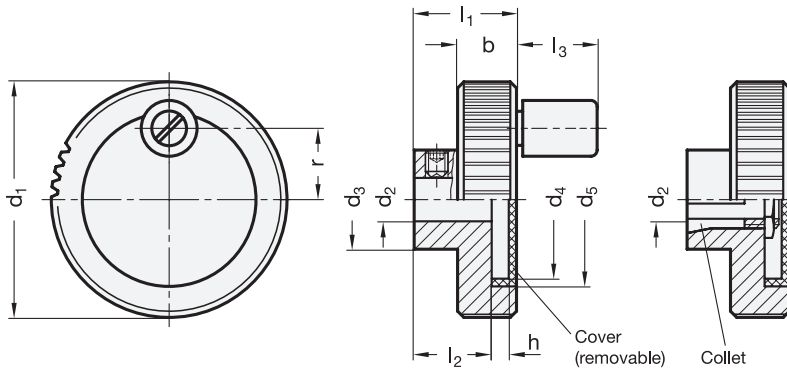

GN 736

Description	d1	d2 H8	d3	d4	d5	b -0.5	h	l1	l2	l3 ≈	r	∅ Handle	⚖
GN 736-52-B10-A	52	10	22	37	39.5	13	3.8	23	17	-	15.5	-	56
GN 736-52-K10-A	52	10	22	37	39.5	13	3.8	23	17	-	15.5	-	59
GN 736-52-Z10-A	52	10	22	37	39.5	13	3.8	23	17	-	15.5	-	65
GN 736-62-B10-A	62	10	25	47	49.5	13	3.8	23	17	-	20.5	-	76
GN 736-62-K10-A	62	10	25	47	49.5	13	3.8	23	17	-	20.5	-	82
GN 736-62-Z10-A	62	10	25	47	49.5	13	3.8	23	17	-	20.5	-	100
GN 736-52-B10-D	52	10	22	37	39.5	13	3.8	23	17	19	15.5	13	69
GN 736-52-K10-D	52	10	22	37	39.5	13	3.8	23	17	19	15.5	13	71
GN 736-52-Z10-D	52	10	22	37	39.5	13	3.8	23	17	19	15.5	13	77
GN 736-62-B10-D	62	10	25	47	49.5	13	3.8	23	17	21	20.5	14	90
GN 736-62-K10-D	62	10	25	47	49.5	13	3.8	23	17	21	20.5	14	94
GN 736-62-Z10-D	62	10	25	47	49.5	13	3.8	23	17	21	20.5	14	112

